

CONTAMINATION OF AIR IN TOILET WASHROOM AFTER HAND DRYING

Average number of bacteria in air immediately after drying poorly washed hands

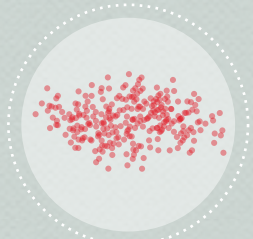

Airborne contamination



Water droplets containing bacteria



Average numbers of bacteria in air* 15 minutes after drying poorly washed hands

*standard volume of air collected for 15 minutes after each hand drying episode.

CFU = Colony Forming Unit

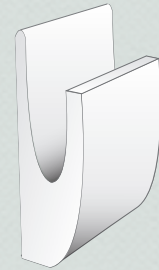

JET AIR DRYER

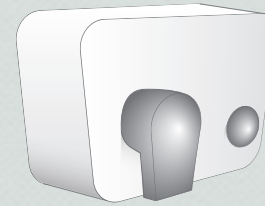
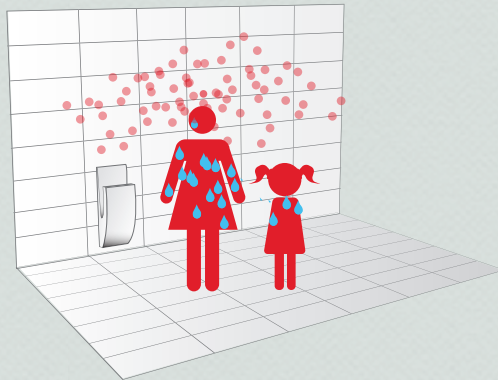

WARM AIR DRYER

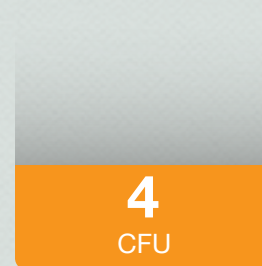
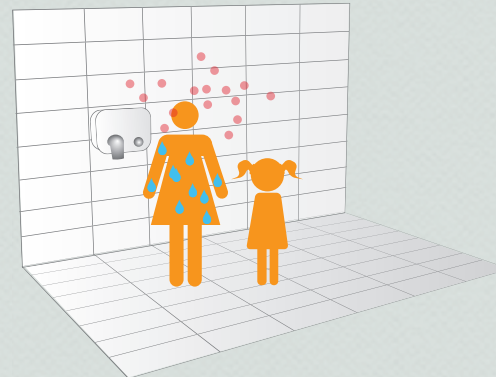
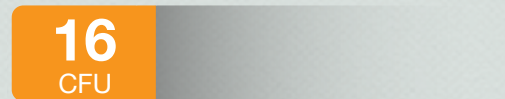

PAPER TOWEL

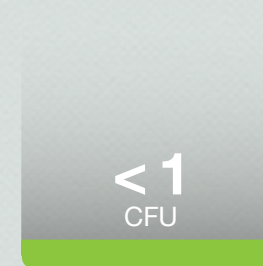
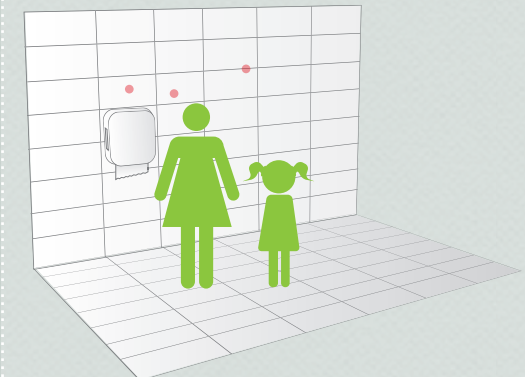
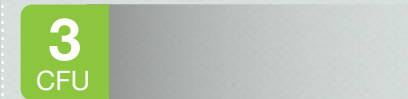

HAND DRYING IS AN IMPORTANT PART OF HYGIENE

WWW.EUROPEANTISSUE.COM